

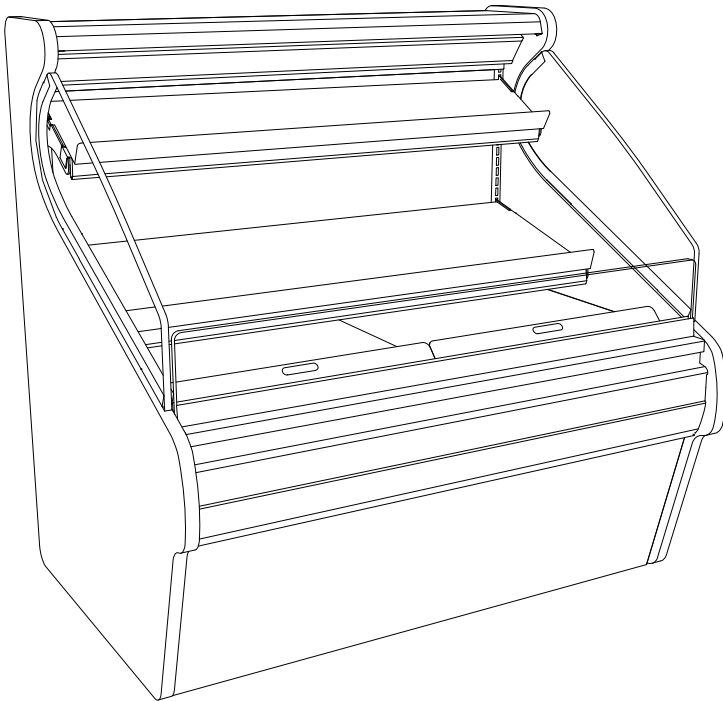

# INSTALLATION AND OPERATING MANUAL

PN 99561

## SELF-SERVICE MERCHANDISER



This Illustration reflects  
Model CO4748



This Illustration reflects  
Models CO5978 and CO7178

Model: CO3678	36" L * x 35" D x 78" H
Model: CO4748	47" L * x 38 3/4" D x 50" H
Model: CO4778	47" L * x 35" D x 78" H
Model: CO5978	59" L * x 35" D x 78" H
Model: CO7178	71" L * x 35" D x 78" H

*\*Includes end panels.*



888 E. Porter Road · Muskegon, MI 49441 Phone: 231.798.8888 Fax: 231.798.4960 www.structuralconcepts.com

## TABLE OF CONTENTS

OVERVIEW AND WARNINGS .....	3
CASE REMOVAL FROM SKID (LEVELERS OR CASTERS) .....	4
START-UP AND OPERATION .....	5
SECURITY COVER (OPTION) .....	6
MAINTENANCE FUNDAMENTALS .....	7
SERIAL LABEL LOCATION & INFORMATION LISTED / TECH INFO & SERVICE.....	13
ILLUSTRATED PARTS BREAKDOWN (Models CO5978 & CO7178) .....	14
PARTS LIST.....	15
TROUBLESHOOTING .....	17
CLEANING SCHEDULE .....	18
WARRANTY .....	19
TECHNICAL SERVICE .....	20

### OVERVIEW

- The Structural Concepts Oasis Self-Service Cases are designed to merchandise packaged bakery products at Ambient product temperatures.
- These cases should be installed and operated according to the following instructions to insure proper performance.
- This unit is designed for the display of products in ambient store conditions where temperatures and humidity are maintained at a maximum of 24°C / 75°F and a relative humidity of 55%.



**WARNING**  
Risk of Electric Shock.  
Disconnect Power Before Servicing Unit



**CAUTION**  
Lamps have been treated to resist breakage and must be replaced with a similarly treated lamp.

## CASE REMOVAL FROM SKID (LEVELERS OR CASTERS)

### **1. Removing Case Shipping Brackets That Are Attached To Skid**

- Remove screws holding Case Shipping Brackets to skid.
- Remove Case Shipping Brackets from Skid.
- See illustrations below. Note: Shipping Brackets will vary in size, shape, material and location depending upon case type and model.

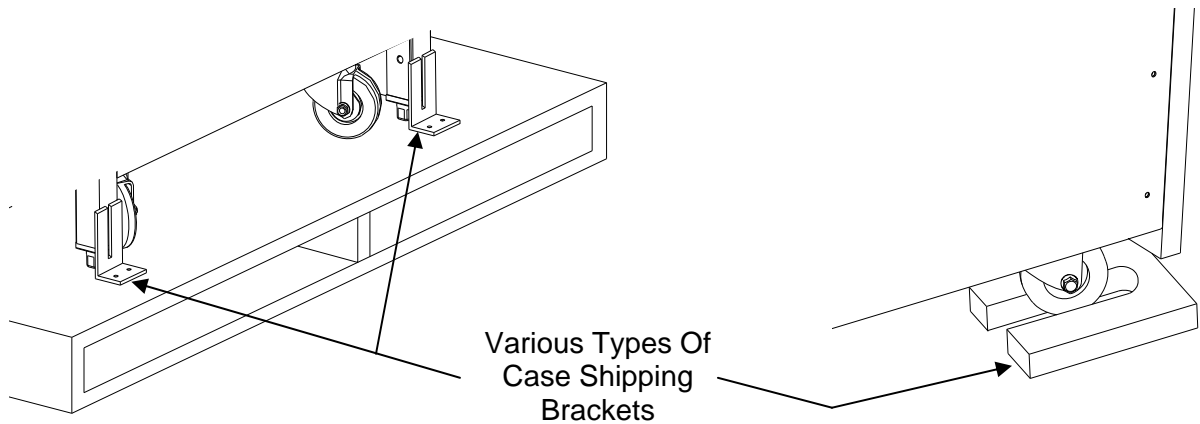

### **2. Remove Case (With Levelers) From Skid**

- To prevent damage, support case while sliding it toward edge of skid.
- When case is at edge of skid, carefully lower to floor (so two levelers rest on floor).
- Carefully slide skid out from under case.
- After removal of case from skid, place into position.
- Note: Illustration below reflects general outline of sample case and does not reflect any particular model or options).

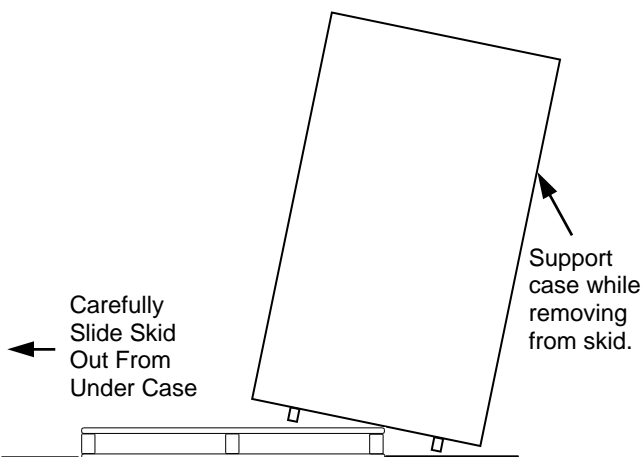

### **3. Remove Case (With Casters) From Skid**

- A. Place ramp up against skid (to allow case to smoothly slide off from skid).
  - B. Maintain support of case at all times or center of gravity may cause case to fall.
  - C. Unlock Casters. Slide unit to rear of skid. Slide down ramp and off from skid.
- Note: Illustrations reflect general outline of sample case and may not reflect your particular model or options).

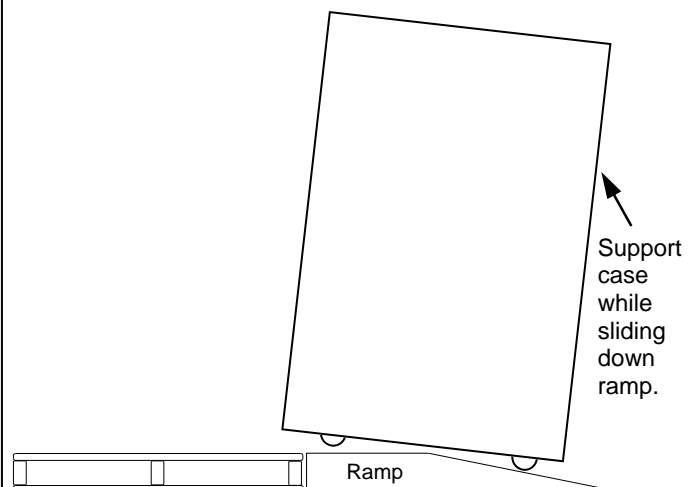

## 1. Merchandiser Start-Up

- **With Power Cord:**
  - *For your safety, equipment is furnished with a properly grounded cord connector. Do not attempt to defeat the grounded connector.*
- Plug cord into a certified electrical outlet with ground.
- **Without Power Cord:**

**Note:** Servicing to be accomplished by certified electrical contractor.

  - **Electrical Leads**
    - Remove 4" x 4" cover from the left

lower rear of the unit.

## 2. Merchandiser Operation

- After power is supplied to the Case, turn on the lights. Light switch is in the interior of the case above and to the left side of the top shelf. All of the lights should come on at the same time.
- First time lighting may require a short warm up period for the bulbs. Slightly dim or a flickering of new bulbs is normal.
- If lights do not turn on, check all of the plug connections.

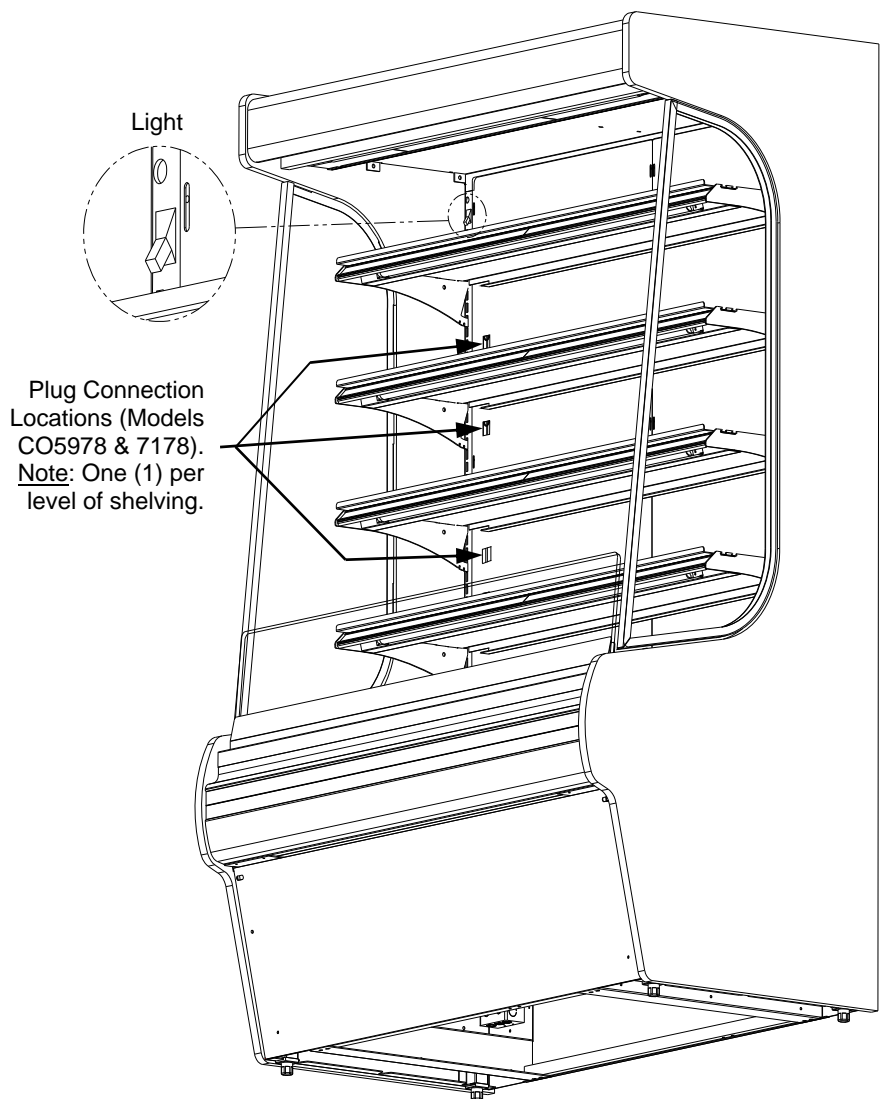

## OPTIONAL SECURITY COVER - INSTALLATION AND REMOVAL (MODELS CO5978 & CO7178)

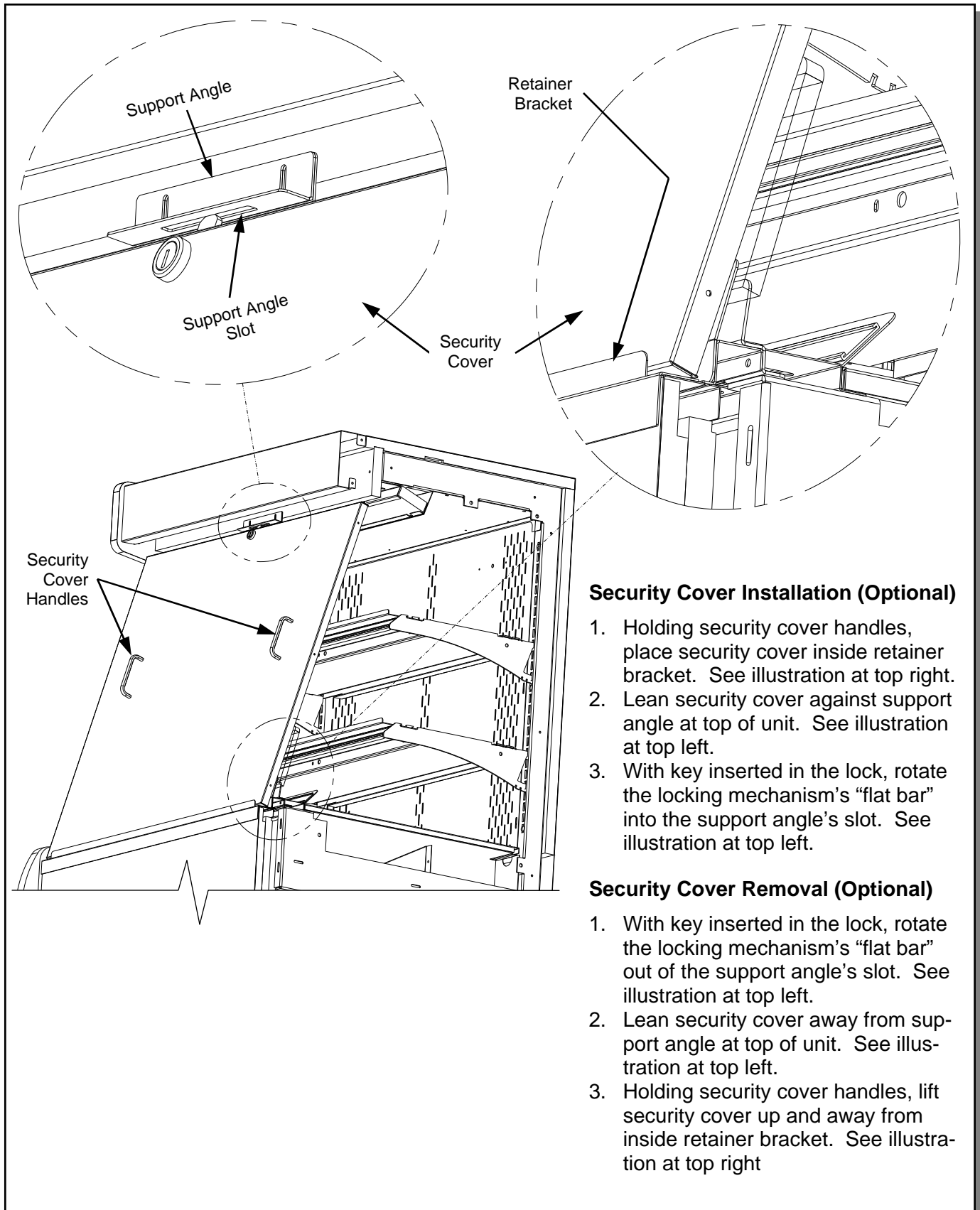

### Security Cover Installation (Optional)

1. Holding security cover handles, place security cover inside retainer bracket. See illustration at top right.
2. Lean security cover against support angle at top of unit. See illustration at top left.
3. With key inserted in the lock, rotate the locking mechanism's "flat bar" into the support angle's slot. See illustration at top left.

### Security Cover Removal (Optional)

1. With key inserted in the lock, rotate the locking mechanism's "flat bar" out of the support angle's slot. See illustration at top left.
2. Lean security cover away from support angle at top of unit. See illustration at top left.
3. Holding security cover handles, lift security cover up and away from inside retainer bracket. See illustration at top right.

## MAINTENANCE FUNDAMENTALS

### 6. Use Butyl / Silicone To Adjoin Multiple Units

Warranty will be voided if improper sealant is used. Lay a generous bead of caulk/sealant as specified below.

- Use Industrial grade butyl caulk on all areas not visible.
- Use industrial grade silicone sealant on visible areas.
- Form Two (2) Caulk/Sealant Lines: Sanitation and Refrigeration (see illustrations below).
- Caulking/sealing tub prevents air from escaping thru seams between cases (which may cause condensation problems and reduced refrigeration efficiency).
- Caulking/sealing also prevents water from seeping between cases to the floor.
- Note: Place thicker bead of caulk around drain.
- See next page for specifics on bolting cases together.

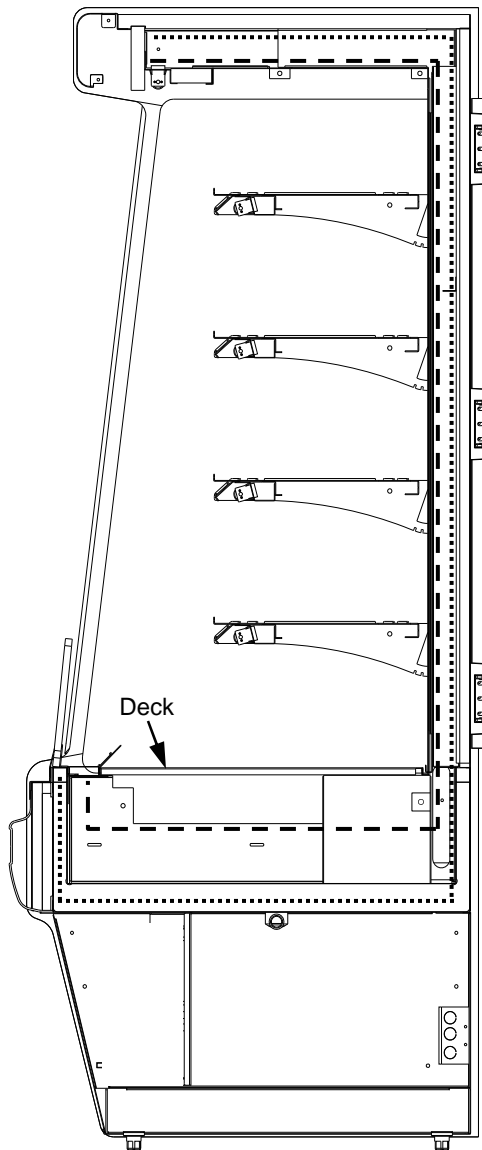

--- Sanitation Caulk Line ---  
..... Refrigeration Caulk Line .....

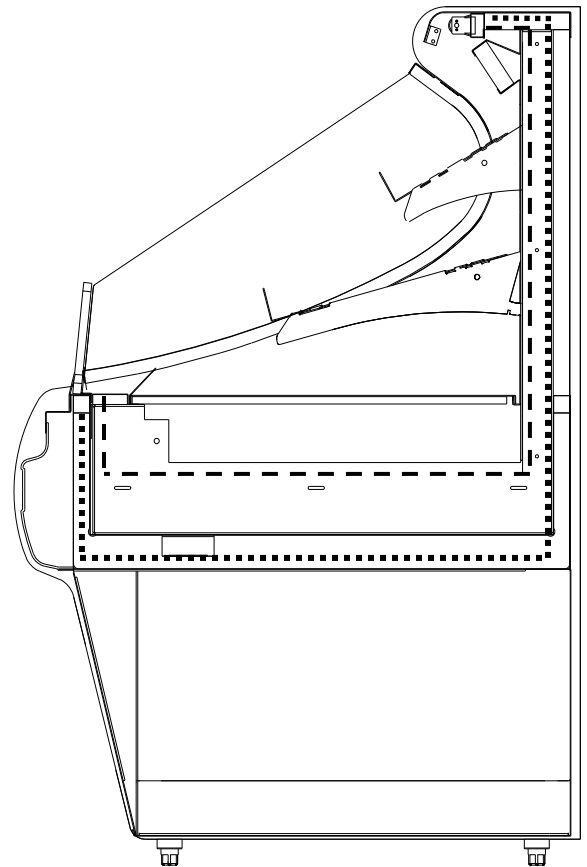

--- Sanitation Caulk Line ---  
..... Refrigeration Caulk Line .....

**Bolting Adjoined Units (CO3678, CO4778, CO5978 and CO7178).**

Units secured together at locations indicated.

- Remove four sheet metal screws from header joiner bracket.
- Bolt Holes are at 9 locations:
- Use 1/4-20 x 1.00" bolts and accompanying nuts to connect units.
- Remove deck pan assembly to access holes 3, 4 & 5.
- See previous page for caulking / sealant specifics.

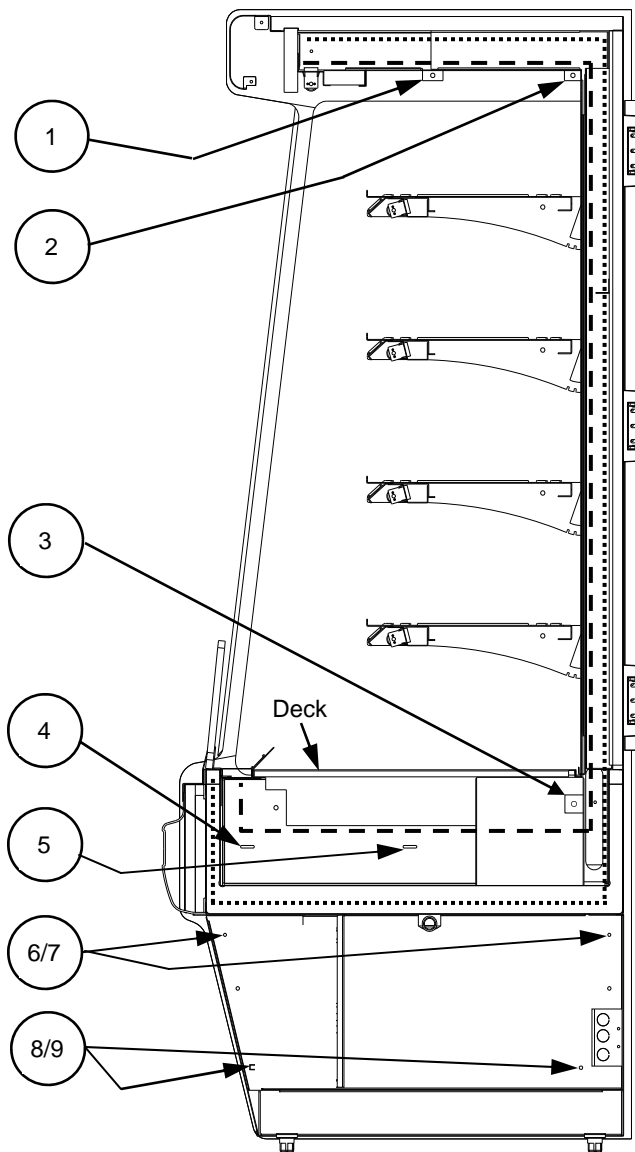

**Bolting Adjoined Units (CO4748).**

Units secured together at locations indicated in below illustration.

- Level and align Cases as necessary prior to joining Cases together.
- Bolt Holes are at 8 locations:
- 1/4-20 x 2.50" bolts and accompanying nuts to connect units.
- Remove Deck Pan assembly to access holes 1, 2, 3 & 4.
- Before fully reassembling components, leak-check case-to-case joint by pouring water on seam.
- See previous page for caulking / sealant specifics.

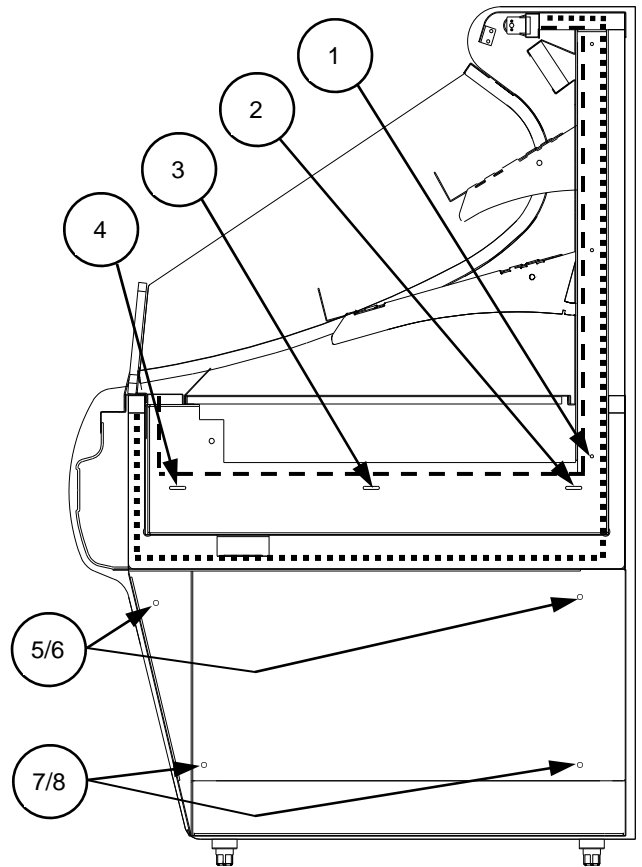

**Joiner Cap & Screws Installation (Models CO5978 & CO7178 shown below). These pieces may not apply to every case.**

- Install the Joiner Cap at connection area between Cases (illustrated below).
- Sheet metal screws are to be used to secure Joiner Cap in place.
- Make certain that screw heads are flush with Joiner cap.
- Note: Illustration below may not be exact representation of every option or feature.

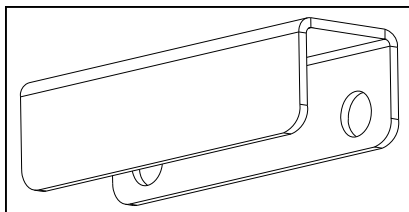
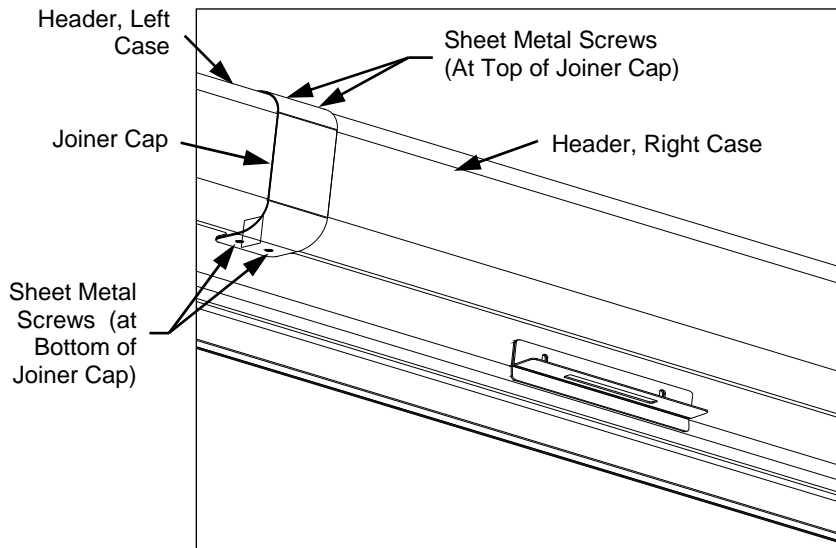

**Retainer Clip**  
For Adjoining Acrylic Sneeze Guards  
**Note:** Clip should hold pieces securely. However, holes provided should retaining screws be required.

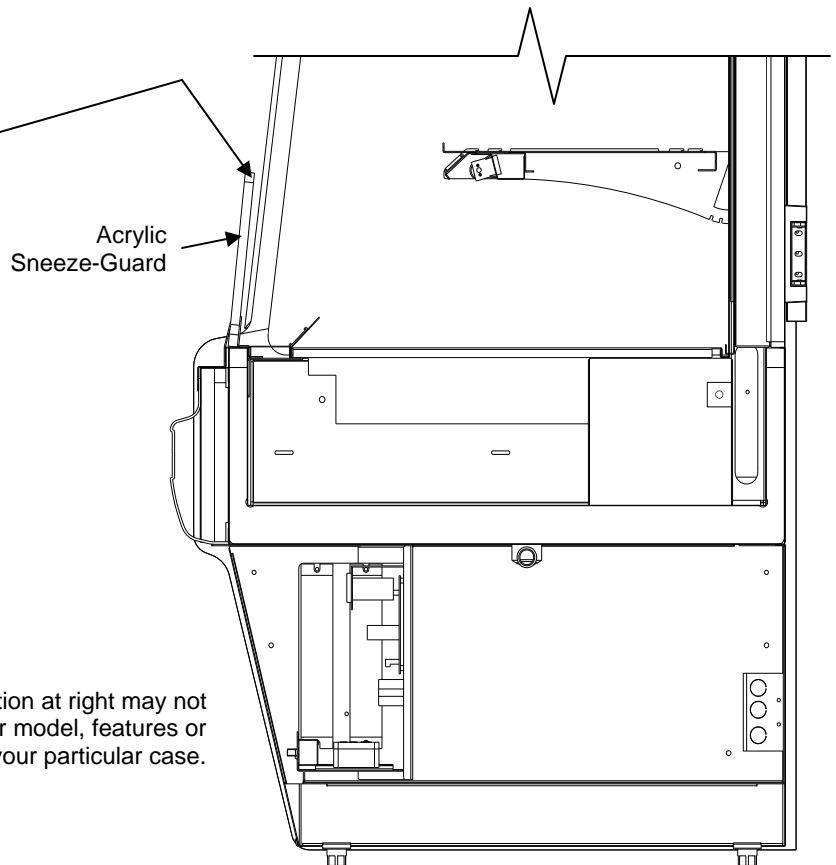

**Note:** Illustration at right may not exactly reflect your model, features or options of your particular case.

### Light Fixture

Fixtures are located on the underside of each shelf assembly and at the top inside of case.

#### Removal of lamp:

- Rotate lamp (1/4 turn) either direction to disengage (upper or lower) pins/contacts from lamp mounting sockets.
- Remove bulb by applying even pressure from the back side at the bulb ends and pulling the remaining contact from the sockets.

#### Installation of lamp:

- Caution! Lamps have been treated to resist breakage and must be replaced with a similarly treated lamp.
- Align pins with slot.
- Insert pins into socket by rotating the bulb 1/4 turn to secure either the (upper or lower) pined contacts into the sockets.
- Rotate the remaining bulb contacts (1/4 turn) into the remaining lamp mounting socket contacts.

### Caster locking operation

- To lock casters push down on lever, to unlock pull up the lever all the way.
- See illustration at right.

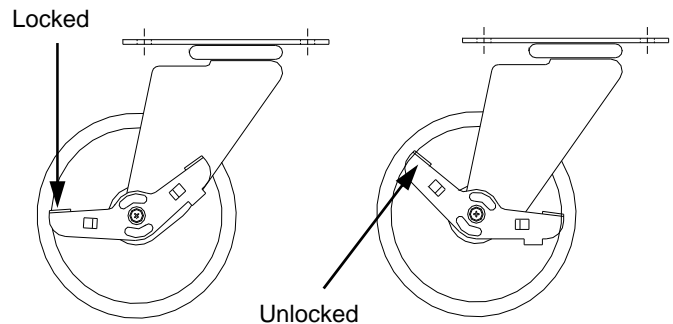
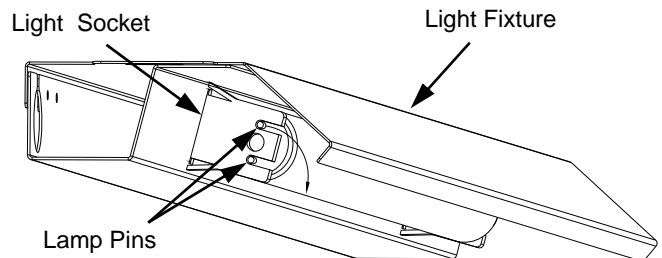

**Shelf Assembly Removal**

- Shelves can be removed for maintenance, cleaning or adjustments
- Slide shelf back about 1/8 inch and rotate front up while lifting shelf assembly.
- For lighted shelving, unplug the light cord.
- Slide light assembly back about 1/8 inch and rotate front up while lifting light assembly.
- Remove brackets. Note it may be necessary to remove the nylon shipping bracket retainer. Pliers will be required to accomplish this task.

**Adjustable Shelves**

- Adjustment of the **angle** of the shelf can be made, not the position.
- Adjustments to the shelves can be made by pivoting the lower portion of the shelf bracket in the upright.
- The shelves can be adjusted to an angle of 0, 5, and 10 degrees.

**Product Rotation**

- To prevent drying out or spoilage of stock, product must be rotated.
- At every re-stocking, rotate old stock to front of shelves and new stock to rear of shelves.

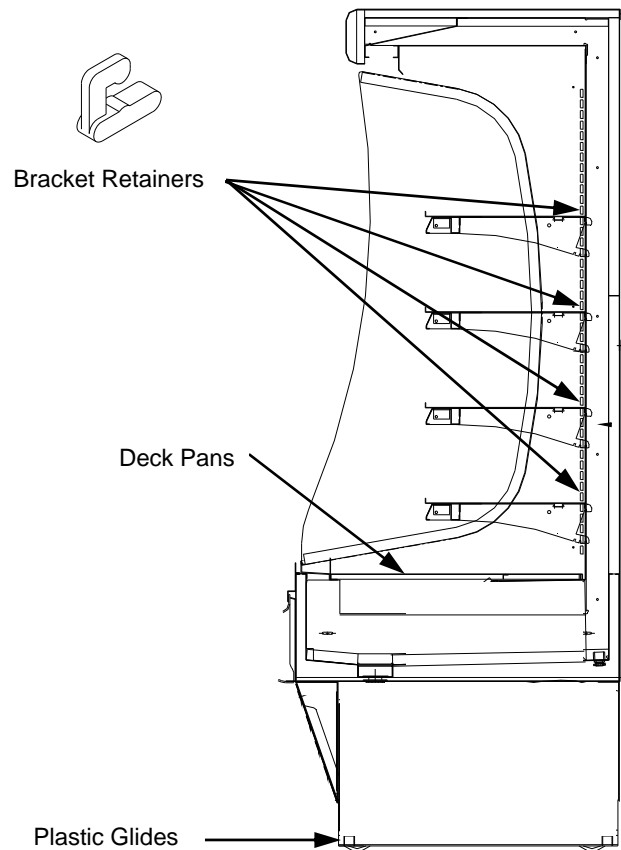
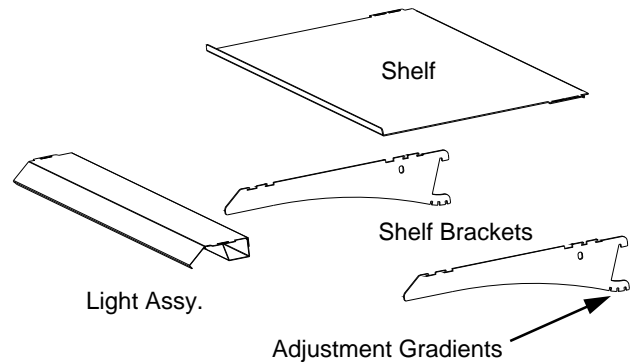
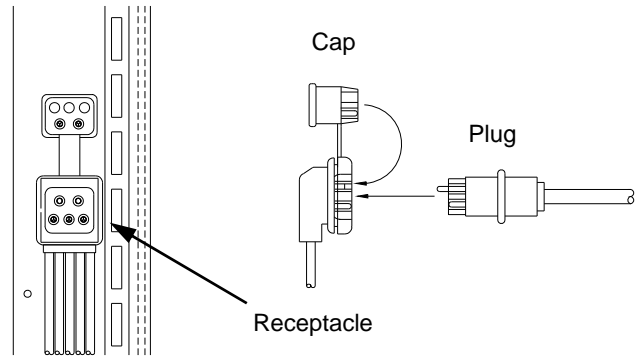

### Ballast Access

- **Assembly or disassembly and servicing to be accomplished by licensed electrical contractor.**
- Remove the front grille by removing the thumb screws located in each of the upper corners.
- Ballast are mounted inside the electrical box on the lower left side of the case.

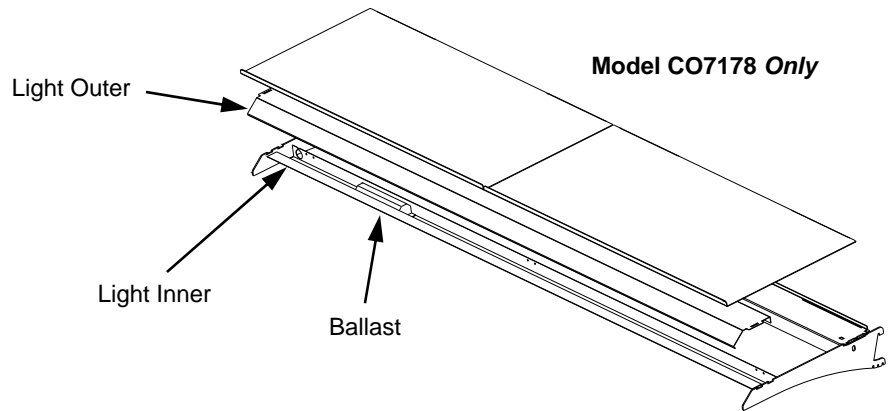
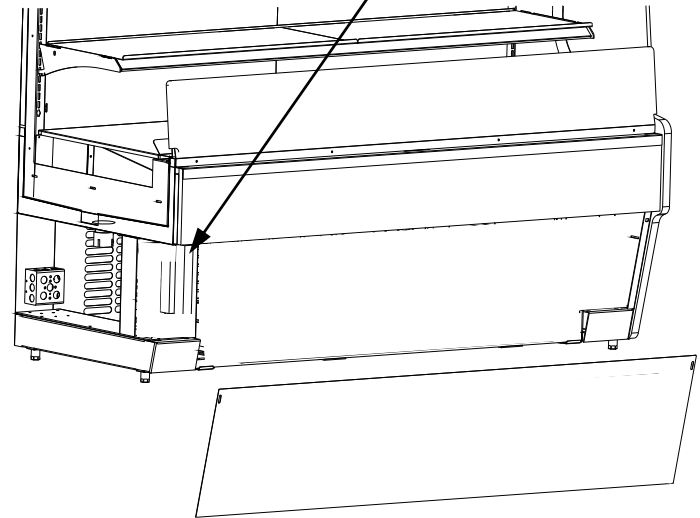
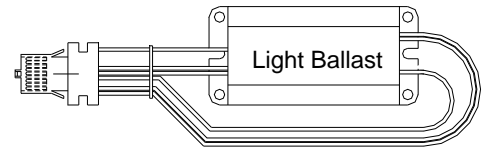

*Note: Model CO7178 has ballasts located in each shelf light assembly.*

- For model CO7178, see shelf assembly illustration, below.
- Disassemble shelf light for access to ballast.
  - Remove screws from the back of shelf assembly.
  - Separate the light outer from the light inner.





**Serial Label Location & Information Listed / Technical Information & Service**

- Serial labels are located near the electrical access on your case.
- Serial labels contain electrical, temperature & refrigeration information, as well as regulatory standards to which the case conforms.
- For additional technical information and service, see the *TECHNICAL SERVICE* page in this manual for instructions on contacting Structural Concepts' Technical Service Department.
- See images below for samples of both refrigerated and non-refrigerated serial labels.

 <p>888 E. Porter Rd · Muskegon, MI 49441</p>		 <p>MODEL HV74RSS SCROLL SERIAL NO.</p>	
<p><b>FOR PARTS AND SERVICE</b> CALL 1-800-433-9489</p>			
 <p>3048256</p>		<p>ELECTRICAL RATING</p>	<p>120/1/60 24A</p>
<p>CONFORMS TO UL STD 471</p>		<p>REFRIGERANT</p>	<p>R404A AMOUNT ?? OZ</p>
<p>CONFORMS TO NSF STD 7</p>		<p>DESIGN PRESSURE</p>	<p>HIGH 450 LOW 200</p>
<p>CERTIFIED TO CAN/CSA STD C22.2 NO 120</p>		<p>MINIMUM CIRCUIT</p>	<p>30A</p>
		<p>MAXIMUM OVERCURRENT</p>	<p>30A</p>
<p>Super Heat Temp</p>		<p>8-10°F</p>	
<p>BTUH Requirements</p>		<p>9,738 BTUH @ 20° F SST</p>	
<p>Defrost</p>		<p>6 defrosts per day, 45° F termination, 45 min. failsafe</p>	

----- Sample Serial Label For Refrigerated Case -----

 <p>888 E. Porter Rd · Muskegon, MI 49441</p>		 <p>PC5682      txtRemote</p>	
 <p>3048256</p>		<p>120 VOLTS      60 HZ      SINGLE PHASE      1.84AMP</p>	<p>txtSerialNumber</p>
<p>CONFORMS TO UL STD 65</p>		<p>FOR PARTS OR SERVICE CALL</p>	
<p>CERTIFIED TO CAN/CSA</p>		<p>STRUCTURAL CONCEPTS</p>	
<p>STD C22.2 NO 120</p>		<p>AT</p>	
		<p>1-800-433-9489</p>	
		<p>N/A</p>	

**SAMPLE ONLY**

----- Sample Serial Label For Non-Refrigerated Case -----

ILLUSTRATED PARTS BREAKDOWN - MODELS CO5978 & CO7178 ONLY

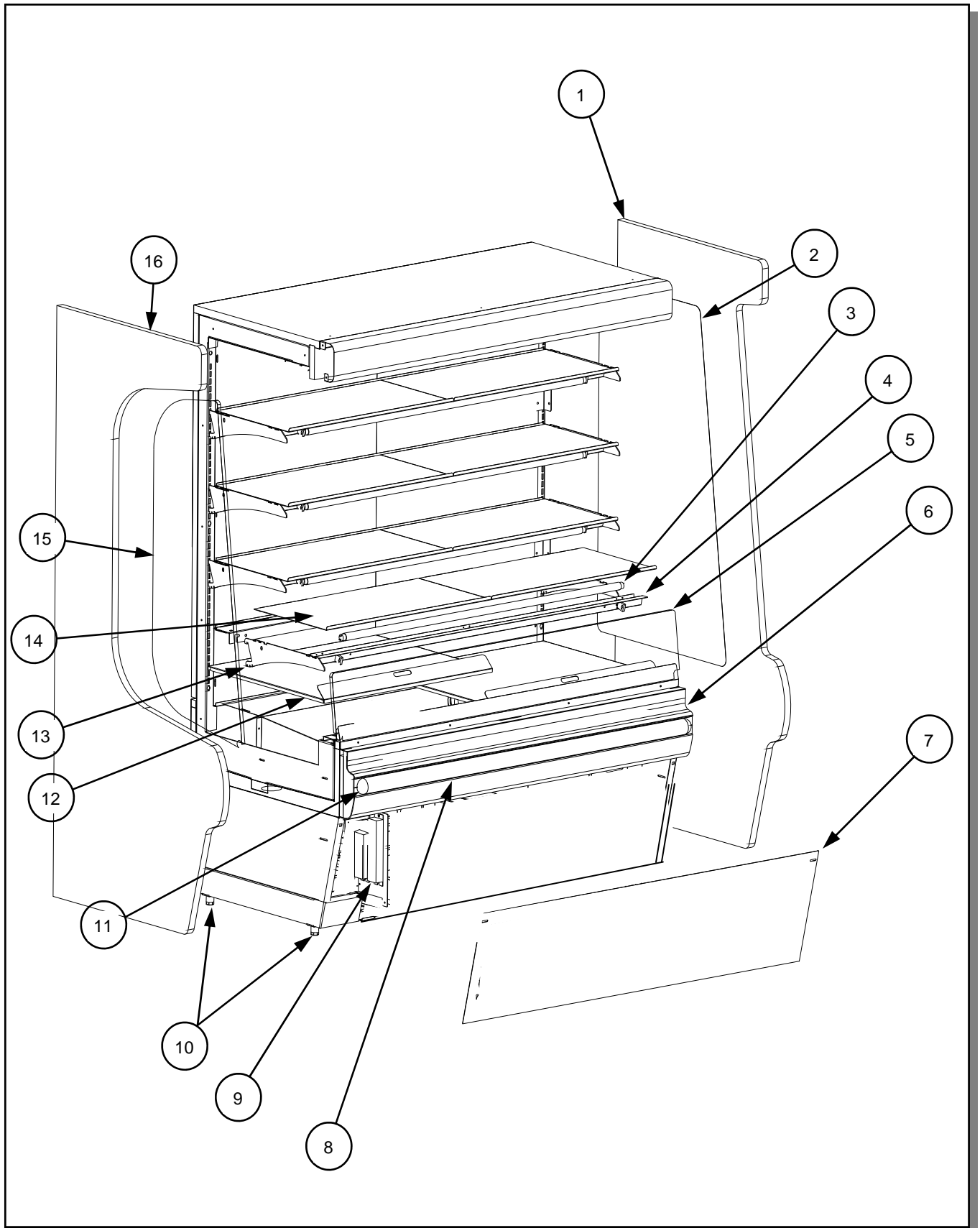

ILLUSTRATED PARTS BREAKDOWN, CONTINUED

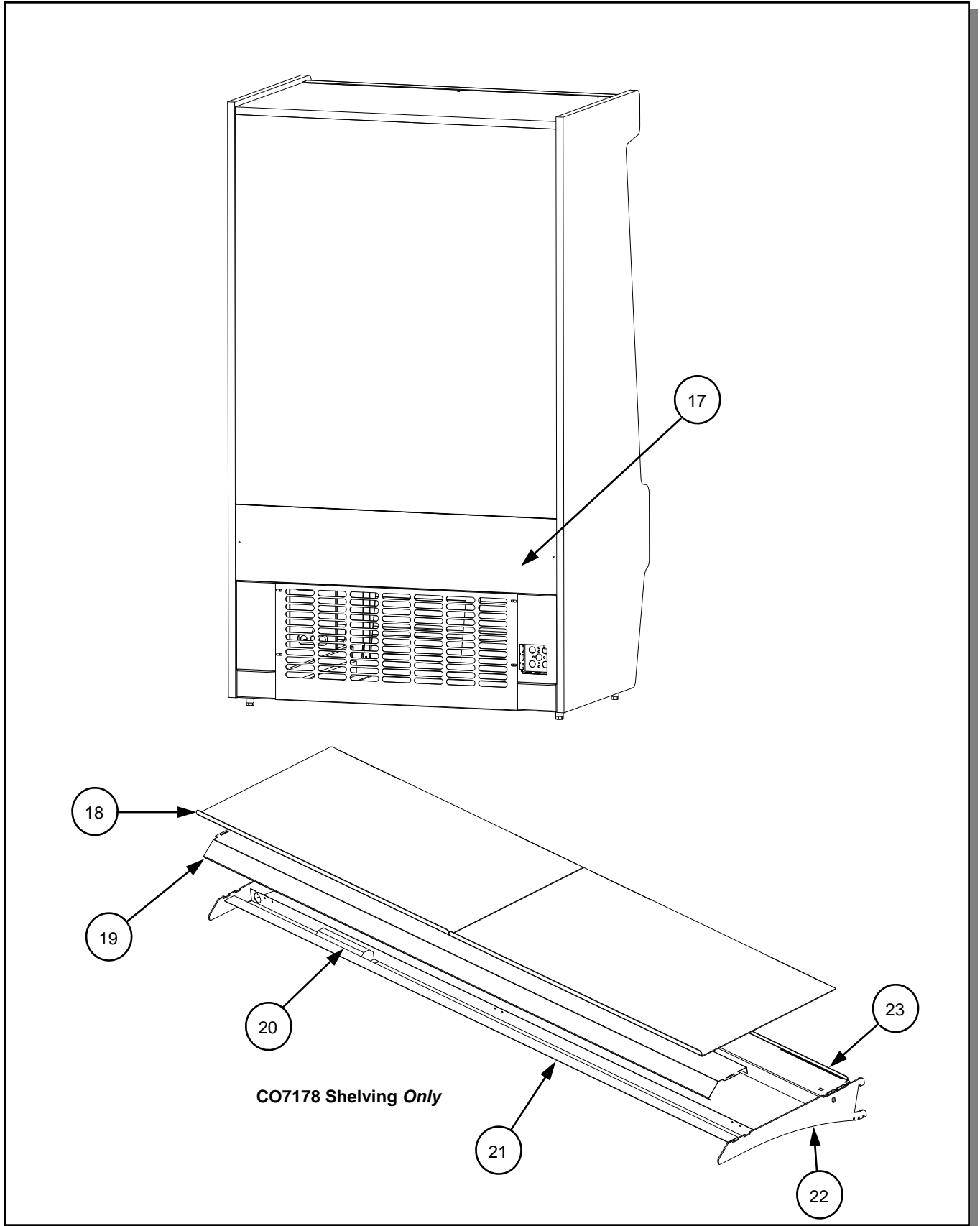

## PARTS LIST

1	End Panel, Full	15	End Glass
2	Mirror	16	End Panel, Cutaway Shown
3	Bulb	17	Rear Back Base
4	Rack Light Assembly	18	Shelf
5	Acrylic Front Air Deflector	19	Light Outer
6	Front Panel, ABS Shown	20	Ballast
7	Front Lower Grill	21	Light Inner
8	Bumper Insert	22	Shelf Bracket
9	Ballast	23	Rear Shelf Support
10	Leveler	24	Channel ID Support
11	Bumper End Cap	25	Magna Bar
12	Deck Pan	26	Peg 12"
13	Shelf Bracket	27	Channel ID
14	Shelf Assembly		

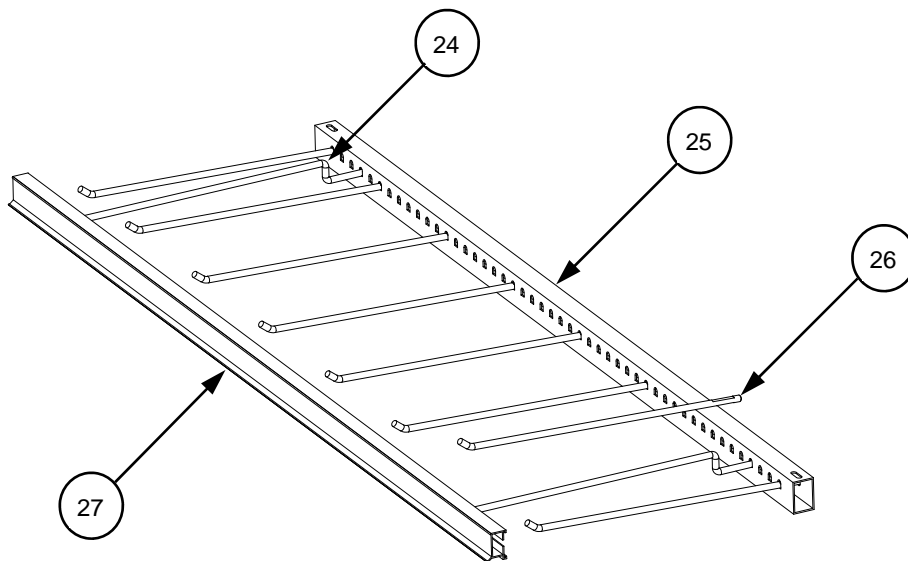

## TROUBLESHOOTING

<b>Case Lights Not Working</b>	Check bulbs for proper installation and connection.
	Check for burned out bulbs.
	Clean dirt and dust from the bulbs to prevent flickering.
<b>Product Drying Out or Spoiling</b>	At every re-stocking, rotate old stock to front of shelves and new stock to rear of shelves.
	Check the relative humidity in the store. See <i>Overview and Warnings</i> section of this manual for acceptable settings.

## CLEANING SCHEDULE

Cleaning	Daily	Weekly	Monthly	Task
Clean Case Exterior	X			The acrylic must be cleaned with a mild soap and water solution and a soft cloth ( <b>never use a household cleaner on acrylic</b> ).
Clean Case Interior	X			Shelves and decks can be cleaned with a warm soap and water solution.
		X		Remove the decks and clean with soap and water.
		X		Vacuum tub under deck. Clean with soap and water. Wipe dry with clean cloth.

## WARRANTY

All sales by Structural Concepts Corporation (SCC) are subject to the following limited warranty. "Goods" refers to the product or products being sold by SCC.

**Warranty; Remedies; Limitations.** SCC warrants that if any Goods are found by an authorized representative of SCC not to be of good material or workmanship within one year of the date of shipments SCC will, at its option after inspection by an authorized representative, replace any defective Good or pay the reasonable cost of replacement for any such defective Goods, provided that written notice of the defect is given to SCC within 30 days of the appearance of such defect. If notice is not given within such period, any claim for breach of warranty shall be conclusively deemed to have been waived and SCC shall not be liable under this warranty. If SCC is unable to repair or replace the defective Goods, SCC shall issue a credit to the Purchaser for all or part of the purchase price, as SCC shall determine. The replacement or payment in the manner described above shall be the sole and exclusive remedy of Purchaser for a breach of this warranty. If any Goods are defective or fail to conform to this warranty, SCC will furnish instructions for their disposition. No Goods shall be returned to SCC without its prior consent.

SCC's liability for any defect in the Goods shall not exceed the purchase price of the Goods. SCC SHALL HAVE NO LIABILITY TO PURCHASE FOR CONSEQUENTIAL DAMAGES OF ANY KIND WHATSOEVER, INCLUDING, BUT NOT LIMITED TO, PERSONAL INJURY, PROPERTY DAMAGE, LOST PROFITS, OR OTHER ECONOMIC INJURY DUE TO ANY DEFECT IN THE GOODS OR ANY BREACH OF SCC. SCC SHALL NOT BE LIABLE TO THE PURCHASER IN TORT FOR ANY NEGLIGENT DESIGN OR MANUFACTURE OF THE GOODS, OR FOR THE OMISSION OF ANY WARNING THEREFROM.

SCC shall have no obligation or liability under this warranty for claims arising from any other party's (including Purchaser's) negligence or misuse of the Goods or environmental conditions. This warranty does not apply to any claim or damage arising for or cause by improper storage, handling, installation, maintenance, or from fire, flood, accidents, structural defects, building settlement or movement, acts of God, or other causes beyond SCC's control.

Except as expressly stated herein, SCC makes no warranty, express, implied, statutory or otherwise as to any parts or goods not manufactured by SCC. SCC shall warrant such parts or Goods only (I) against such defects, (II) for such periods of time, and (III) with such remedies, as are expressly warranted by the manufacturer of such parts of Goods. Notwithstanding the foregoing, any warranty with respect to such parts of Goods and any remedies available as a result of a breach thereof shall be subject to all of the procedures, limitations, and exclusions set forth herein.

THE WARRANTIES HEREIN ARE IN LIEU OF ALL WARRANTIES, EXPRESS, IMPLIED, STATUTORY, OR OTHERWISE. IN PARTICULAR, SCC MAKES NO WARRANTY OF MERCHANTABILITY OR FITNESS FOR A PARTICULAR PURPOSE.

No representative, agent or dealer of SCC has authority to modify, expand, or extend this Warranty, to waive any of the limitations or exclusions, or to make any different or additional warranties with respect to Goods.

**Period of Limitations.** No claim, suit or other proceeding may be brought by Purchaser for any breach of the foregoing warranty or this Agreement by SCC or in any way arising out of this Agreement or relating to the Goods after one year from the date of the breach. In the interpretation of this limitation on action for a breach by SCC, it is expressly agreed that there are no warranties of future performance of the goods that would extend that period of limitation herein contained for bringing an action.

**Indemnifications.** Purchaser agrees to indemnify, hold harmless, and defend SCC if so requested, from any and all liabilities, as defined herein, suffered, or incurred by SCC as a result of, or in connection with, any act, omission, or use of the Goods by Purchaser, its employees or customers, or any breach of this Agreement by Purchaser. Liabilities shall include all costs, claims, damages, judgments, and expenses (including reasonable attorney fees and costs).

**Remedies of SCC.** SCC's rights and remedies shall be cumulative and may be exercised from time to time. In a proceeding or action relating to the breach of this Agreement by Purchaser, Purchaser shall reimburse SCC for reasonable costs and attorney's fees incurred by SCC. No waiver by SCC of any breach of Purchaser shall be effective unless in writing nor operate as a waiver of any other breach of the same term thereafter. SCC shall not lose any right because it has not exercised it in the past.

**Applicable Law.** This Agreement is made in Michigan and shall be governed by and interpreted according to Michigan law. Any lawsuit arising out of this Agreement or the Goods may be handled by a federal or state court whose district includes Muskegon County, Michigan, and Purchaser consents that such court shall have personal jurisdiction over Purchaser.

**Miscellaneous.** If any provision of this Agreement is found to be invalid or unenforceable under any law, the provision shall be ineffective to that extent and for the duration of the illegality, but the remaining provisions shall be unaffected. Purchaser shall not assign any of its rights nor delegate any of its obligations under this Agreement without prior written of SCC. This Agreement shall be binding upon and inure to the benefit of SCC and Purchaser and each of their legal representatives, successors and assigns.

SCC warrants its products to be free of defects in materials and workmanship under normal use and service for a period of one (1) year from the date of delivery.

This warranty is extended only to the original purchaser for use of the Goods. It does not cover normal wear parts such as plastic tongs, tong holders, tong cables, bag holders, or acrylic dividers.

**General Conditions.** All service labor and/or parts charges are subject to approval by SCC. Contact the Customer Service Department in writing or call 231-798-8888.

All claims must contain the following information: (1) the model and serial code number of the equipment; (2) the date and place of installation; (3) the name and address of the agency which performed the installation; (4) the date of the equipment failure; and (5) a complete description of the equipment failure and all circumstances relating to that failure.

Once the claim has been determined to be a true warranty claim by SCC's Customer Service Department, the following procedure will be taken: (1) replacement parts will be sent at no charge from SCC on a freight prepaid basis; (2) reimbursement for service labor will be paid if the following conditions have been met— (a) prior approval of service agency was awarded from the Customer Service Department; and (b) an itemized statement of all labor charges incurred is received by the Customer Service Department. The cost of the service labor reimbursement will be based on straight time rates and reasonable time for the repair of the defect.

If problems occur with any compressor, notify SCC's Customer Service Department immediately. Any attempt to repair or alter the unit without prior consent from the Customer Service Department will render any warranty claim null and void. This warranty and protection plan does not apply to any condensing unit or any part thereof which has been subject to accident, negligence, misuse, or abuse, or which has not been operated in accordance with the manufacturer's recommendations or if the serial number of the unit has been altered, defaced, or removed.

**Limit of Liability.** The limit of liability of SCC toward the exchange cost of the original condensing unit, F.O.B. SCC, Norton Shores, MI, of each motor-compressor assembly replaced during the warranty shall not exceed manufacturer's current established wholesaler's exchange price and in no case shall the labor of removing or replacing the motor-compressor or parts thereof be the responsibility of SCC.

**STRUCTURAL CONCEPTS CORPORATION  
TECHNICAL SERVICE DEPARTMENT  
1.800.433.9489**